

# **OPENX SAMPLE PLANSET**

**This sample planset is for demonstrating appearance, sheet layout, and plan preparation only. The design content is illustrative and not intended for design or construction use.**

**Refer to applicable Manuals, Standards, and Guidelines for actual design requirements. This sample is not a substitute for compliance with engineering standards.**

# BR-0093 CROSS SECTION INDEX

-L-	X-2 THROUGH X-15
-DWY1-	X-16 THROUGH X-17
-DWY2-	X-18 THROUGH X-19

**STATE OF NORTH CAROLINA  
DIVISION OF HIGHWAYS**

PROJ. REFERENCE NO.	SHEET NO.
BR-0093	X-1A

**CROSS-SECTION SUMMARY**

NOTE: EMBANKMENT COLUMN DOES NOT INCLUDE BACKFILL FOR UNDERCUT

Station L	Uncl. Exc. (cu. yd.)	Embt (cu. yd.)
12+50.00	0	0
13+00.00	237	2
13+50.00	798	13
14+00.00	1314	21
14+50.00	1508	21
15+00.00	1225	21
15+50.00	498	22
16+00.00	28	62
16+40.52	0	294
Station L	Uncl. Exc. (cu. yd.)	Embt (cu. yd.)
19+30.52	0	0
19+50.00	0	91
20+00.00	0	130
20+50.00	1	15
21+00.00	5	7
21+50.00	20	3
22+00.00	90	1
22+50.00	77	0
Station DWY1	Uncl. Exc. (cu. yd.)	Embt (cu. yd.)
10+50.00	0	0
10+75.00	0	1
11+00.00	0	2
11+25.00	1	2
Station DWY2	Uncl. Exc. (cu. yd.)	Embt (cu. yd.)
11+25.00	0	0
11+50.00	3	1
11+75.00	14	1

**Approximate quantities only. Clearing and Grubbing, Shoulder Borrow, Fine Grading and Removal of Existing Asphalt Pavement will be paid for at the lump sum price for "Grading".**



12+00.00

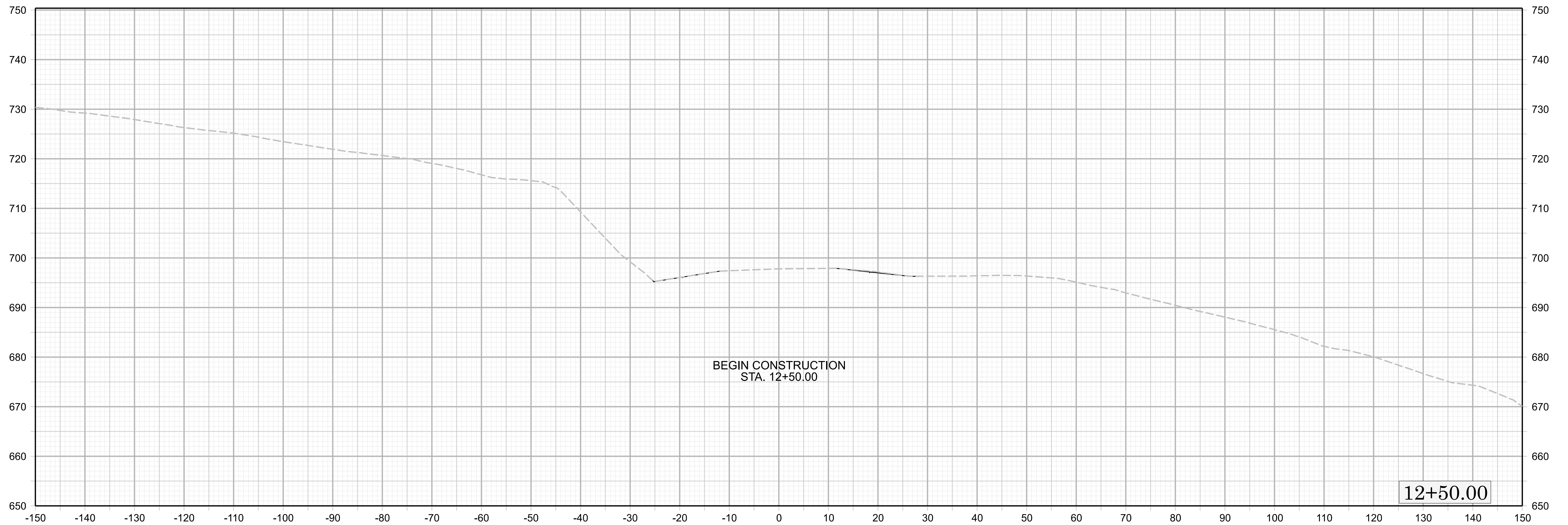

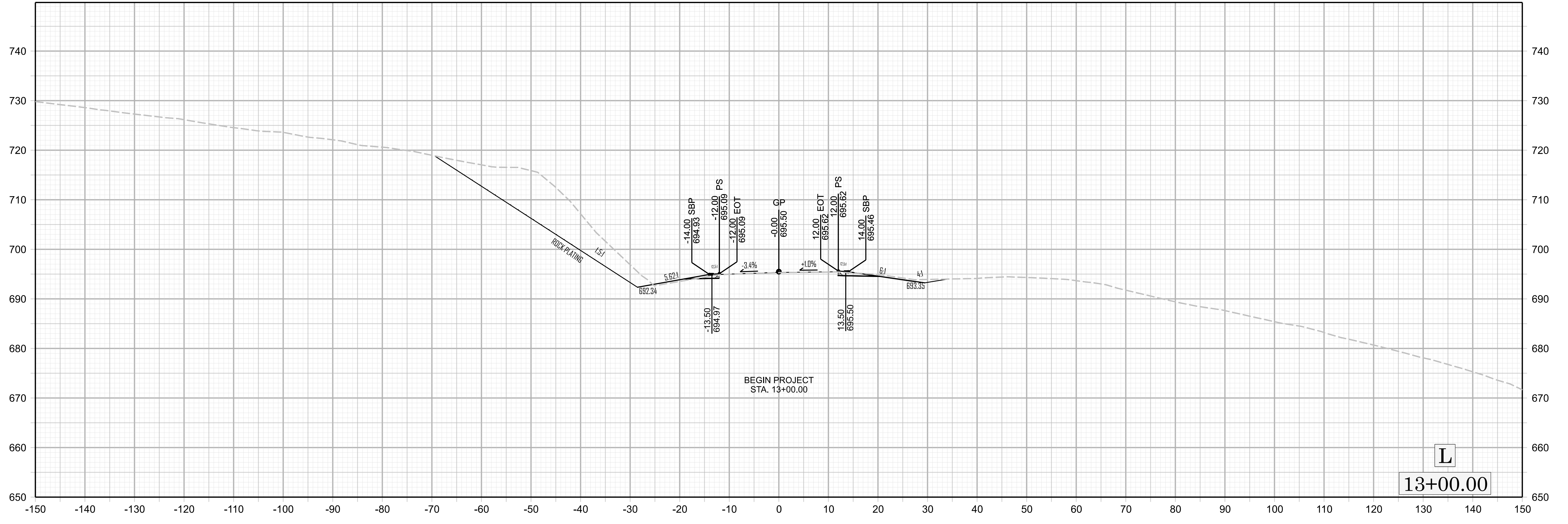

L  
13+00.00

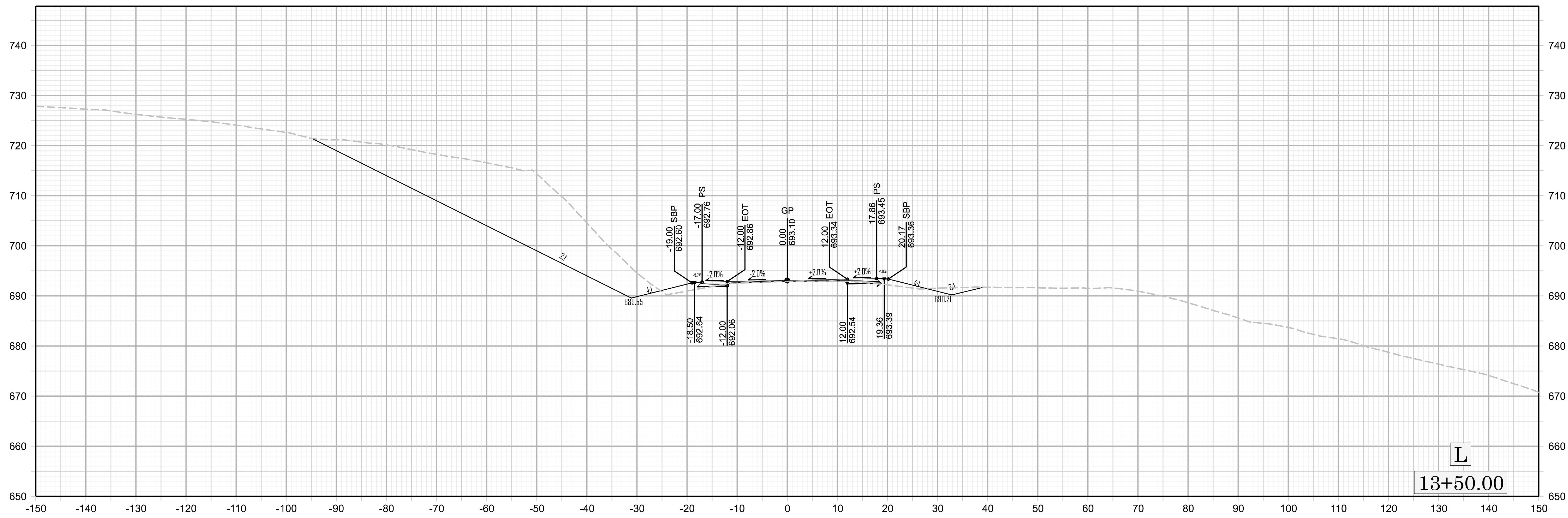

L  
13+50.00

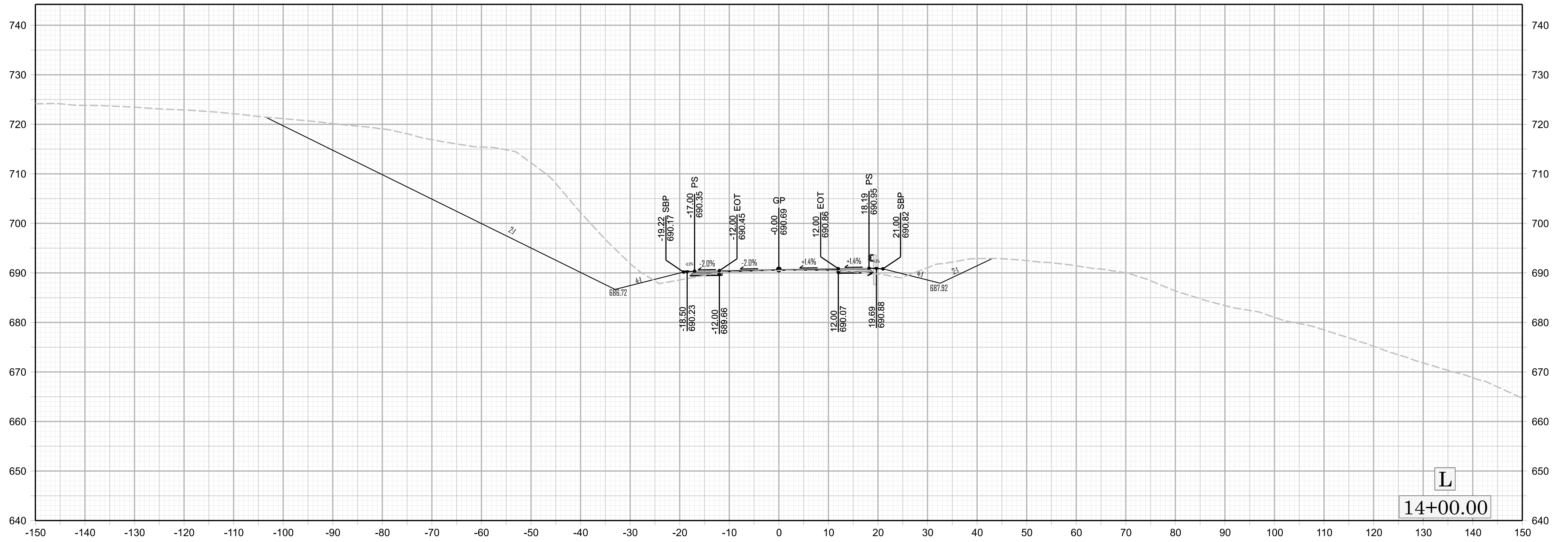



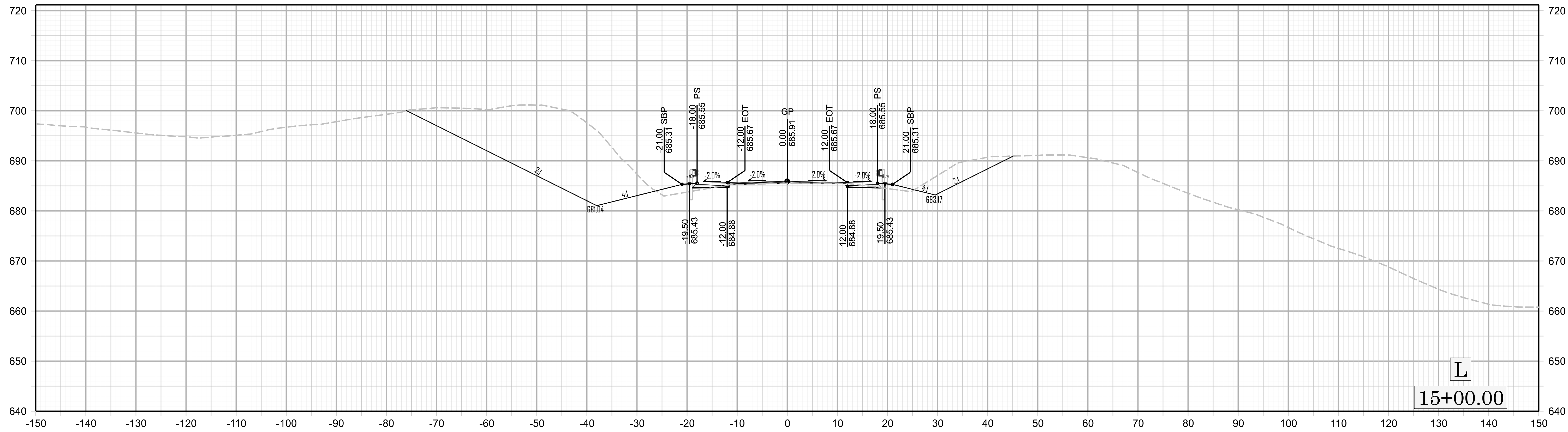

L  
15+00.00

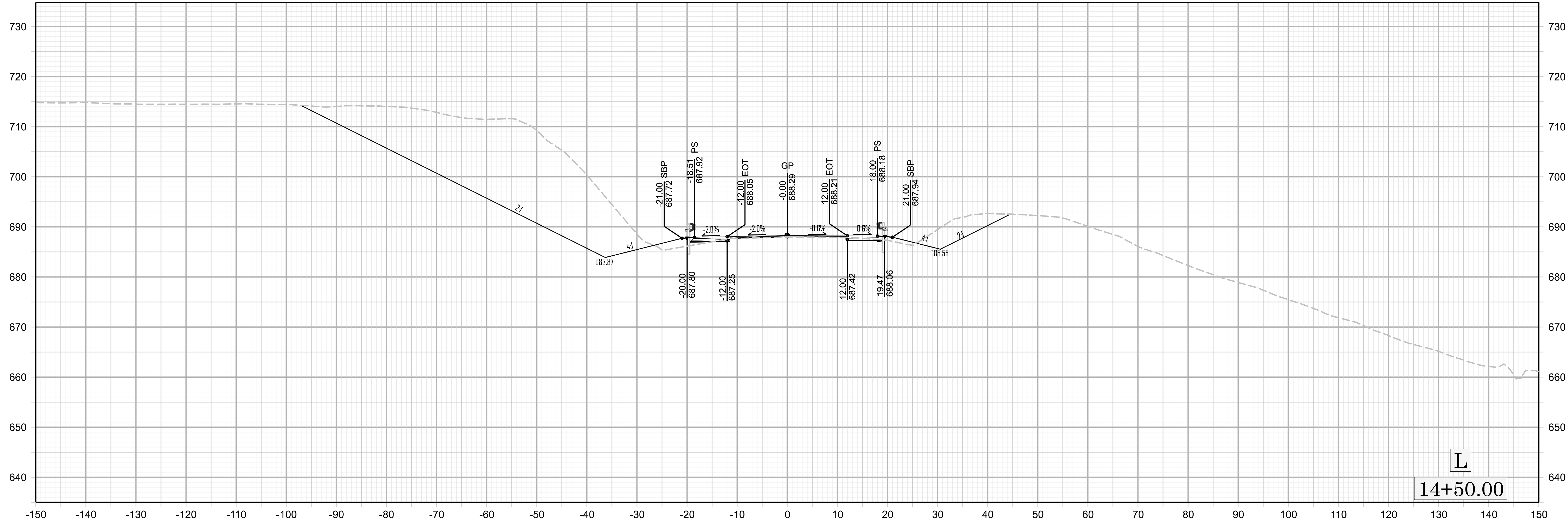

L  
14+50.00

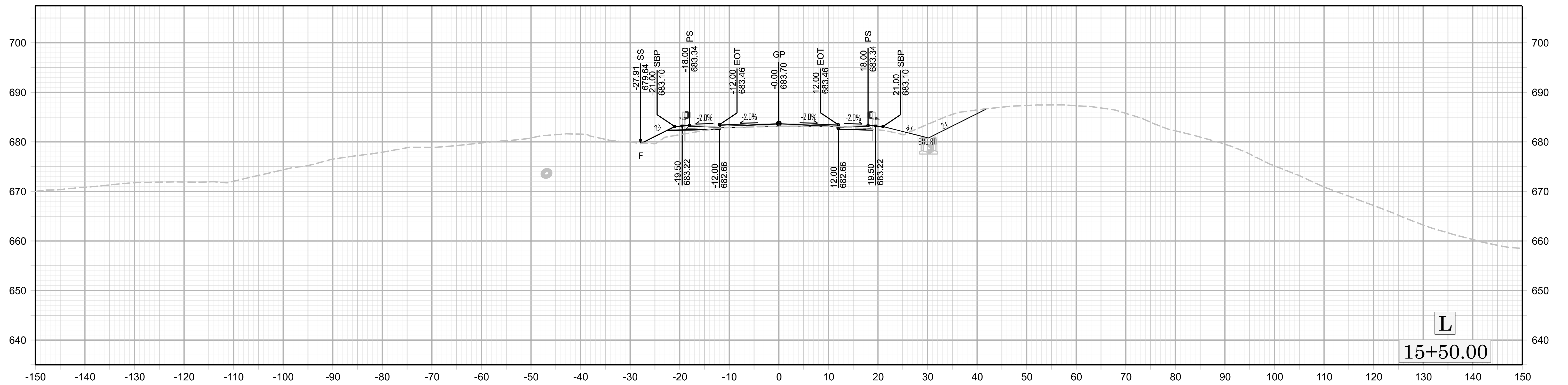
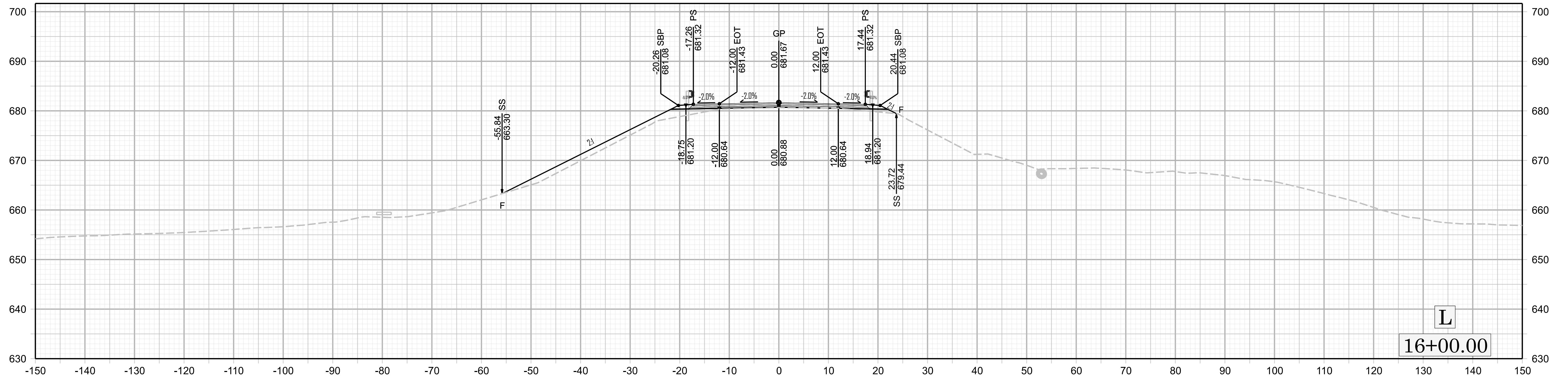

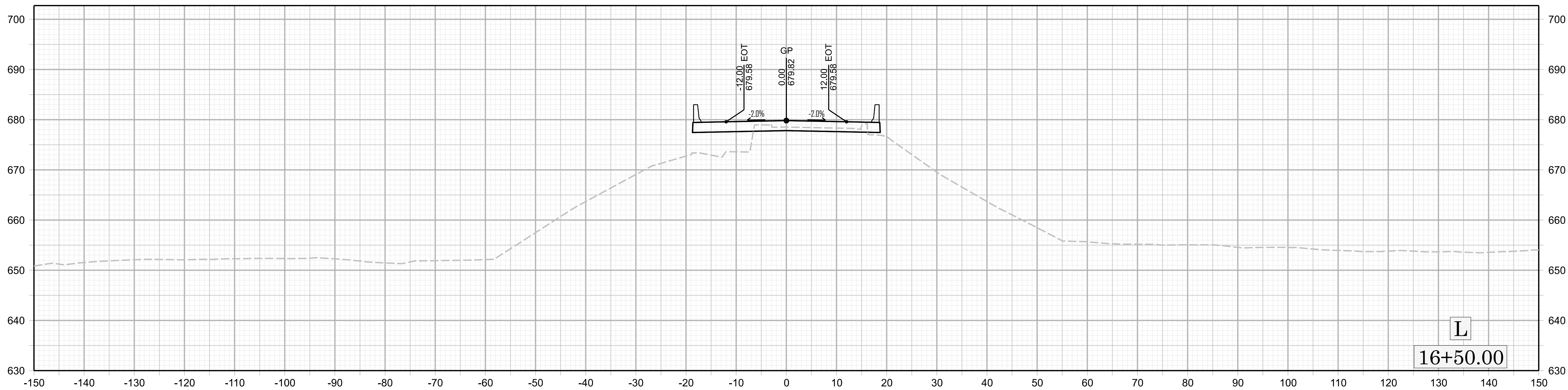
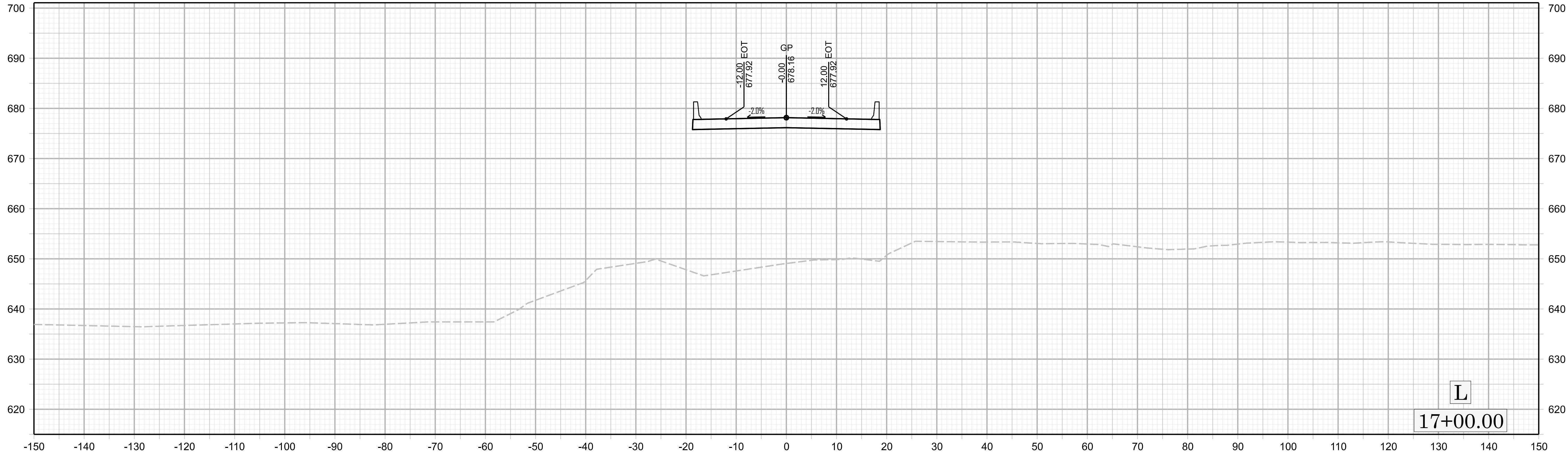

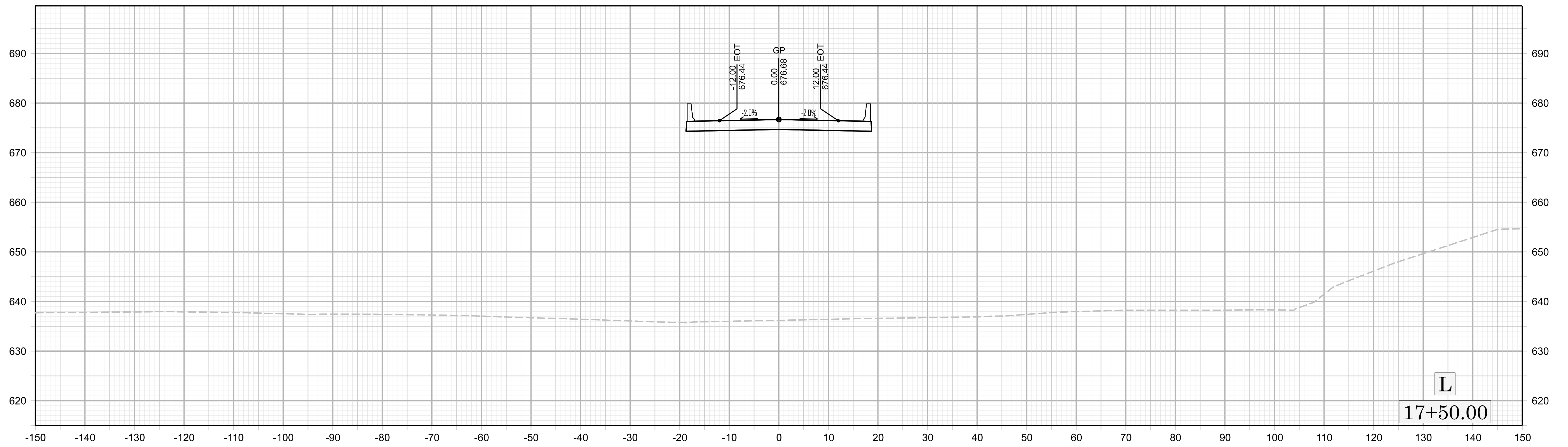
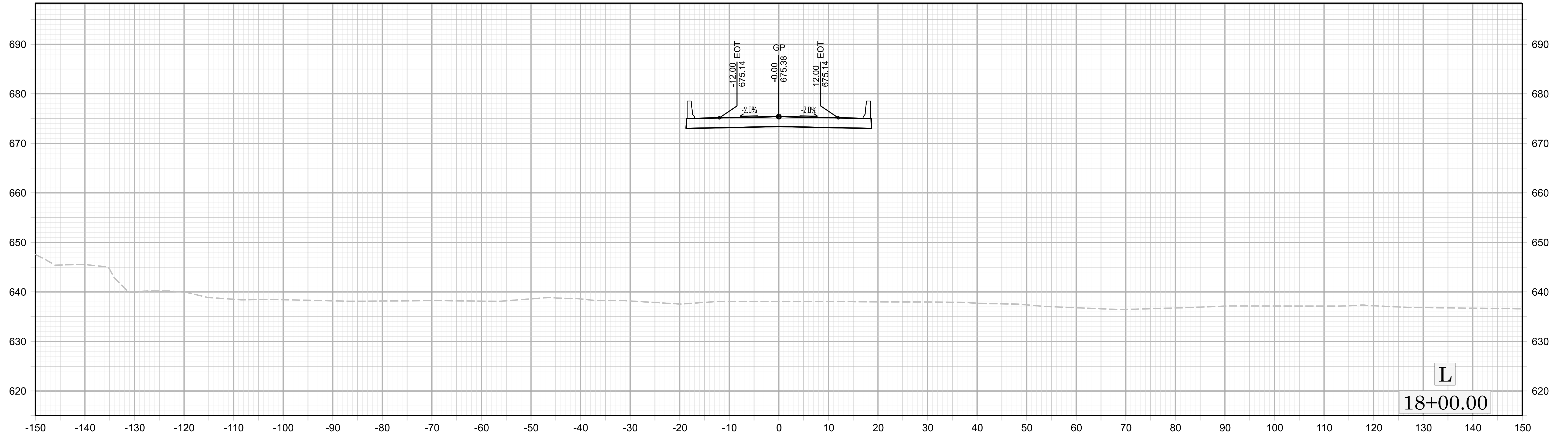

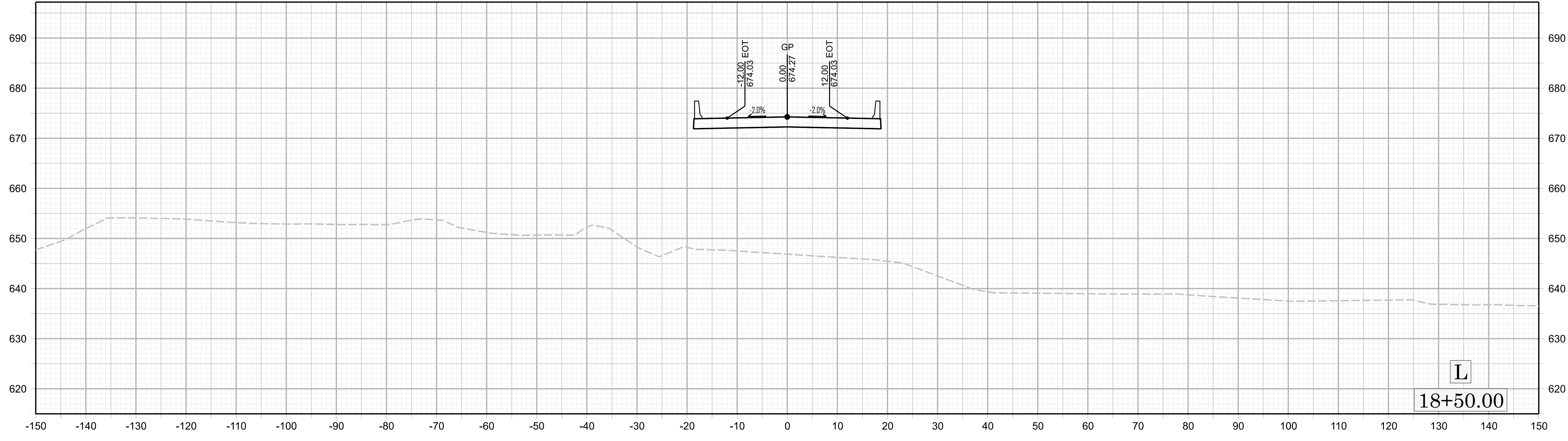
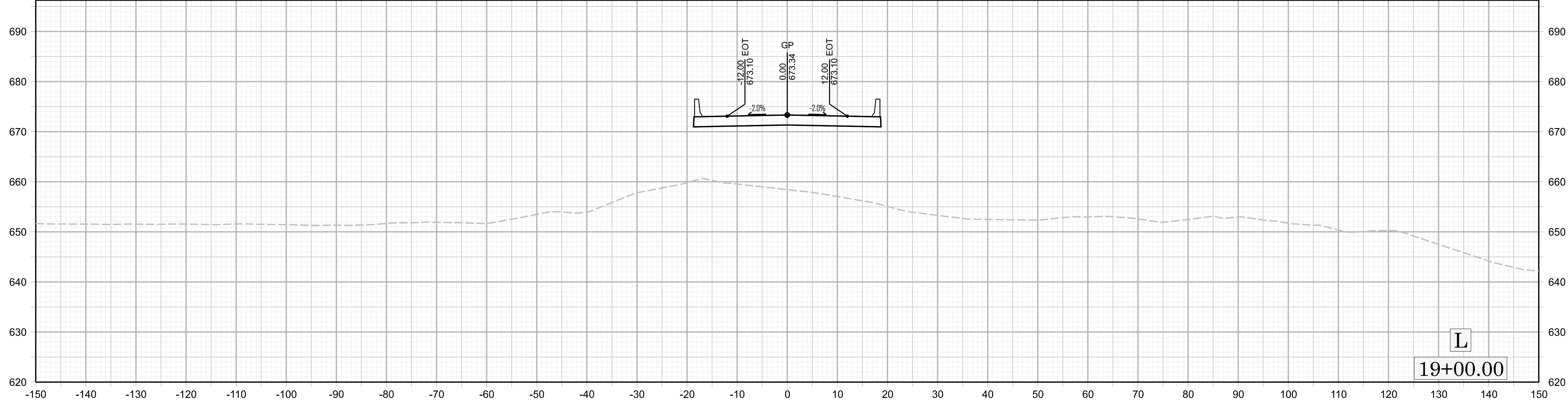

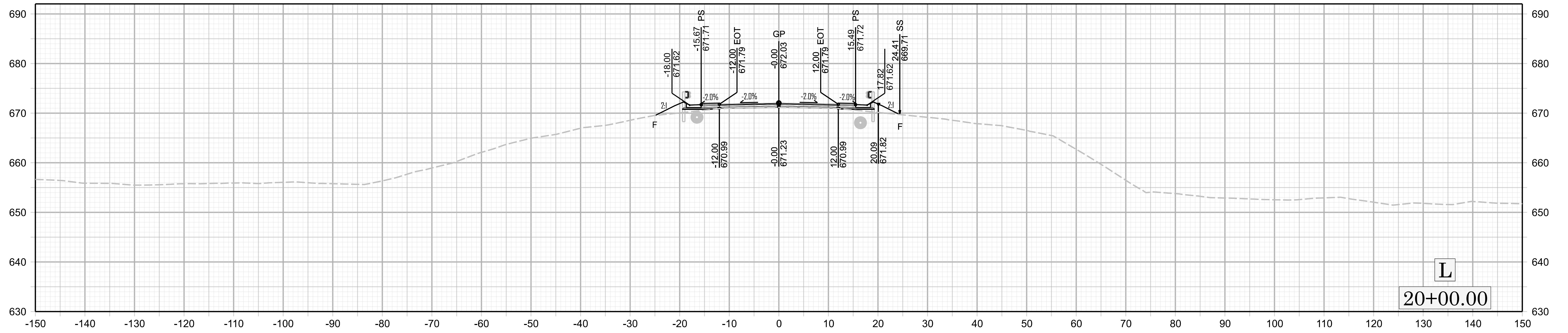

L  
 20+00.00

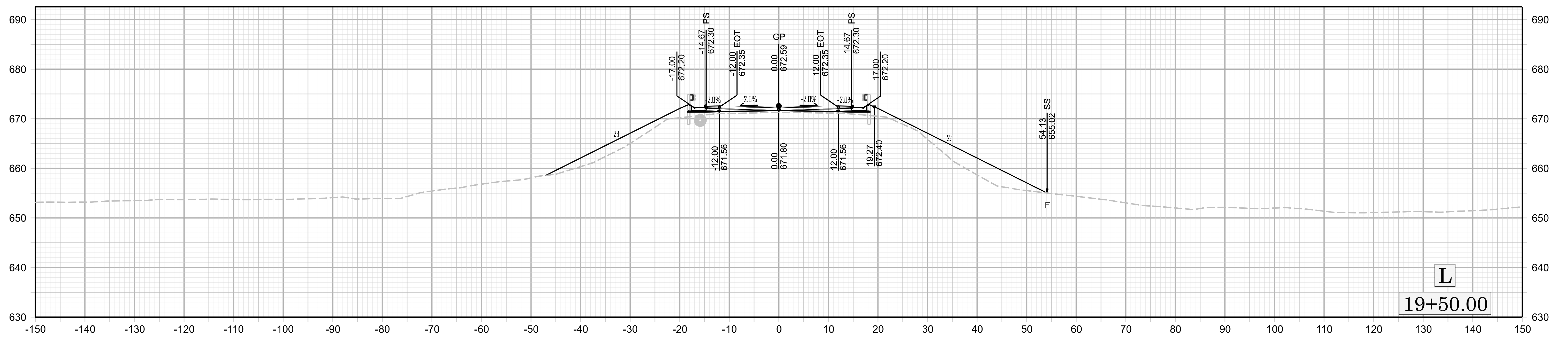

L  
 19+50.00

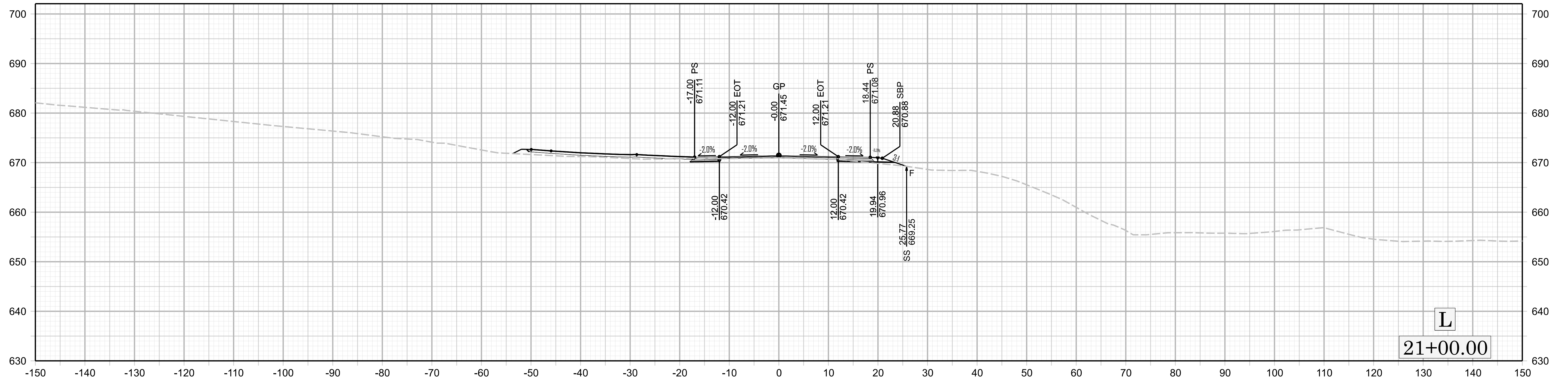

L

21+00.00

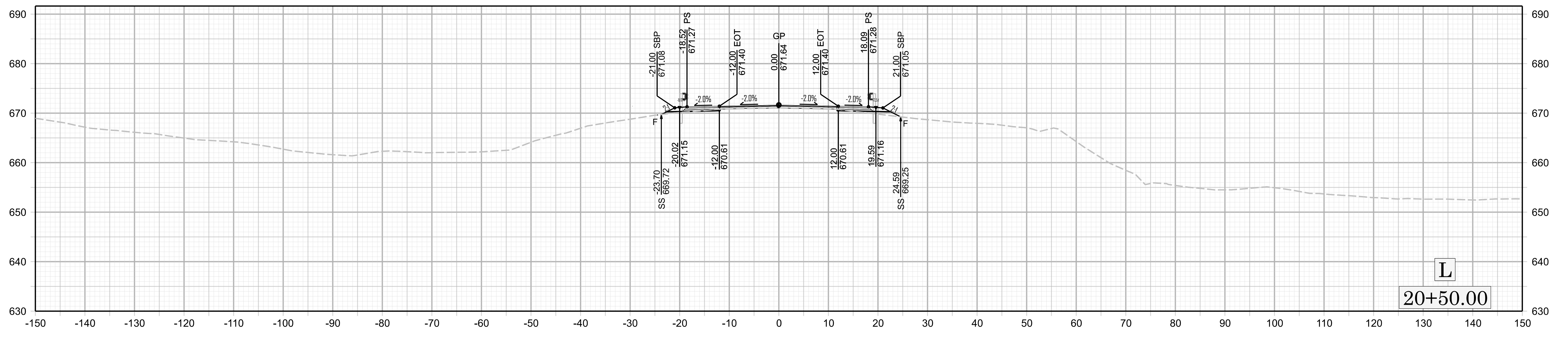

L

20+50.00

